

SITE NUMBER:	12028
BUILDING TYPE:	GLOBAL NEXT GEN 30
ASSET TYPE:	FREESTANDING
CLASSIFICATION:	REFRESH
OWNER:	GROUP W
BASE VERSION:	2022
UPGRADE CLASSIFICATION:	N/A
PROJECT YEAR:	2024
DESIGN TYPE:	GLOBAL
DRAWING RELEASE:	SPRING 2023



© 2024 Baysinger Partners Architecture
 PROJECT TYPE: REMODEL
 GLOBAL NEXT GEN 30

Wendy's
 37251 HWY 26 - MT HOOD HWY
 SANDY, OR 97055

REV	DATE	DESCRIPTION
▲		
▲		
▲		

ISSUE DATE: 04.12.2024
 PROJECT NUMBER: GP 24005
 DRAWN BY: JML
 CHECKED BY: MAV

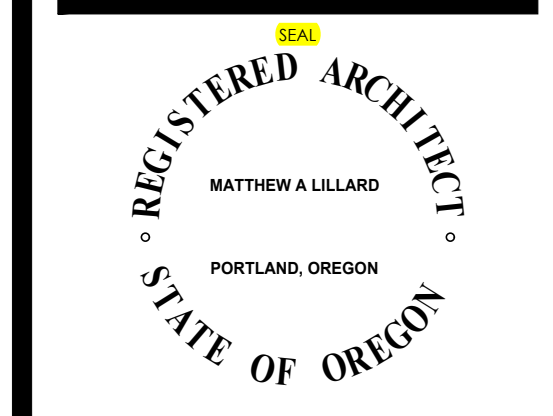

SHEET NAME
 SITE PLAN

SHEET NUMBER
AS1.0

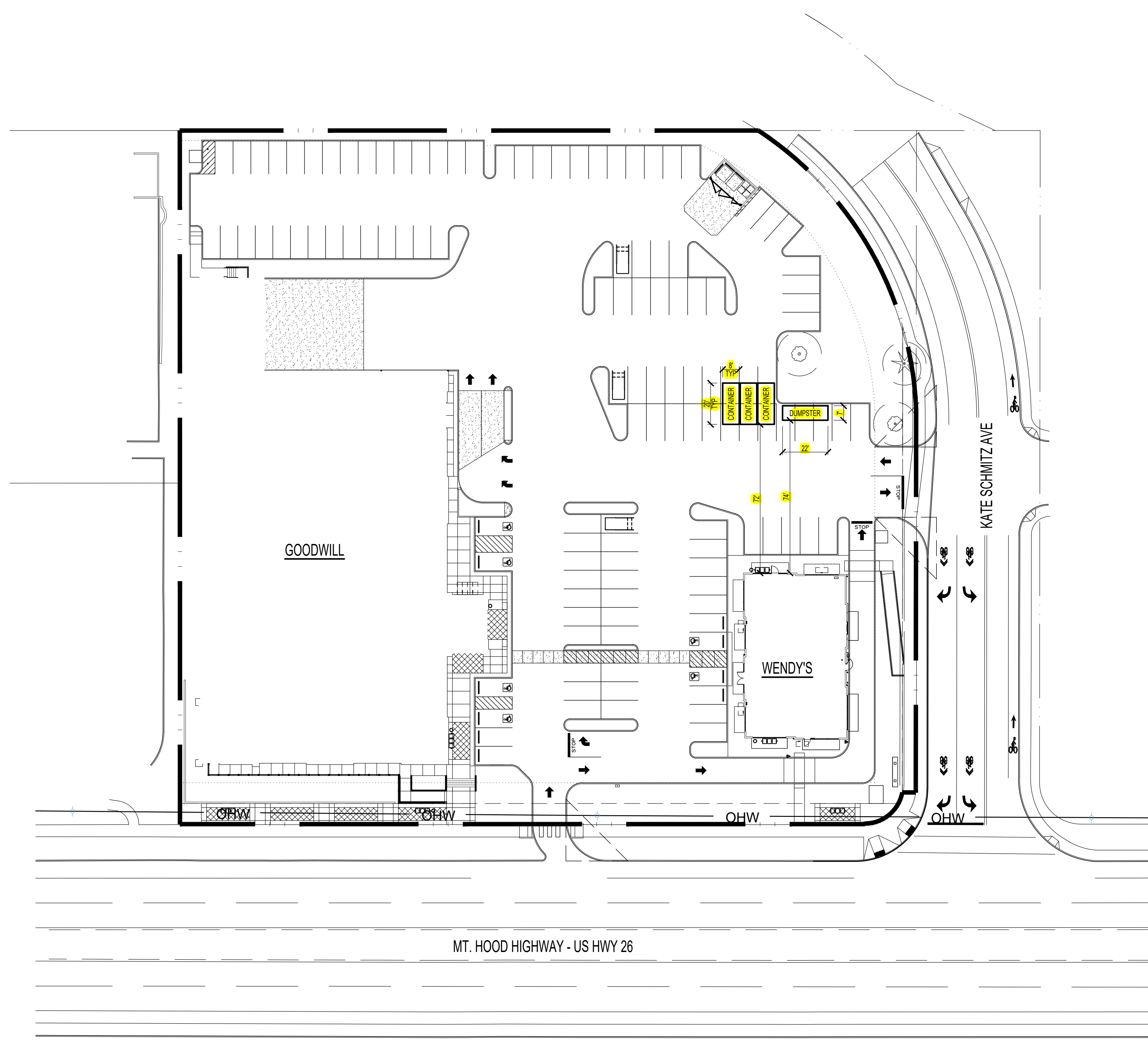

01 SITE PLAN
 SCALE: 1"=30'-0"

06/2024, 9:25 AM, H:\GP\Group W\Partners\GP 24005 Wendy's Sandy\E-DRAWINGS\Sheet01\AS1.0_Site Plan.dwg, jermah